

Revolution® LT

High-Volume, Low-Speed (HVLS) Fan

An Economical Approach to Environmental Control



Performance

- » Formed aluminum blades incorporate tilt, taper, and twist to produce consistent airflow across the entire length of the blade, minimizing dead spots under the center of the fan
- » Covers 22,000 sq. ft., moving air up to 85 ft. in all directions from the center of the fan
- » Improves comfort and productivity by increasing evaporative cooling
- » Creates a healthier workplace with improved airflow and ventilation
- » Helps reduce moisture accumulation and stagnant air pockets

Safety

- » All fans feature a three-way motor-to-hub safety connection, as well as stabilizing cables and motor housing
- » A unique safety ring is provided for back-up security for the motor-to-hub connection. Each hub "resilient arm" is connected to the safety ring.
- » NFPA fire shutdown ready

Warranties

- » 3 year parts, 1 year labor warranty
- » 10 year structural integrity warranty
- » Lifetime warranty on workmanship of blades and hub
- » 12-month limited money-back guarantee
- » Listed to UL507 Standard



Construction

- » Precision-milled layered aluminum hub and bolt
- » IE3 industrial gear motor for premium efficiency, reliability and long life
- » Vibration-dampening material is incorporated into the blade-to-hub mounting to reduce stress to the hub by 50 to 75%
- » The blade and hub are rotationally balanced for smooth, efficient performance
- » Fan weights vary by size and mounting configuration. Approximate weight is 300 lbs.

Single Fan Controller

- » Wired communication between touch screen interface and fan control box
- » Enclosure size is 6" (w) x 4 3/4" (h) with a 4" screen, measured diagonally
- » View and adjust On/Off settings, fan speed and system diagnostics
- » Requires standard 110V outlet



Single Fan Controller

SPECIFICATIONS/SURVEY

Date _____
 Company Name _____
 Address _____
 City _____
 State _____ Zip Code _____
 Representative _____
 Salesperson _____
 Quantity _____ Signature _____

Fan Diameter

- 8' (2440 mm)
- 12' (3660 mm)
- 16' (4880 mm)
- 20' (6100 mm)
- 24' (7320 mm)

Mounting Option

I-Beam Bracket

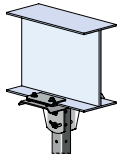

Truss Kit

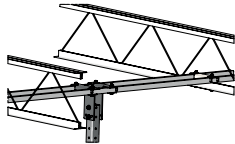

Purlin Kit

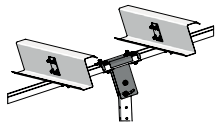

Laminated
Beam Kit

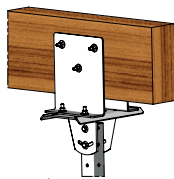

Fan Drop Height (See Chart) **B**

- 43" (1100 mm) (No Drop Tube)
- 56" (1430 mm)
- 68" (1730 mm)
- 86" (2190 mm)
- 98" to 125" (2490 mm to 3175 mm)
- 216" to 285" (5490 mm to 7240 mm)

Drop tubes may be cut on site to decrease Fan Drop Height. See the Owner's Manual for cut lengths and fan clearances.

A Roof Surface to Mounting Surface	Fan Drop Height B Minimum height required for air intake		
	16' Fan Diameter	20' Fan Diameter	24' Fan Diameter
6" (160 mm)	56"	68"	86"
12" (310 mm)	56"	68"	86"
18" (610 mm)	56"	56"	68"
24" (610 mm)	43"	56"	68"
36" (920 mm)	43"	43"	56"
48" (1220 mm)	43"	43"	56"

Minimum Fan Drop Height for all 8 ft and 12 ft fans is 43" (1100 mm).
 Minimum Fan Drop Height assumes a flat roof surface.
 Fan Drop Height may need to be increased for roofs with a steeper pitch.

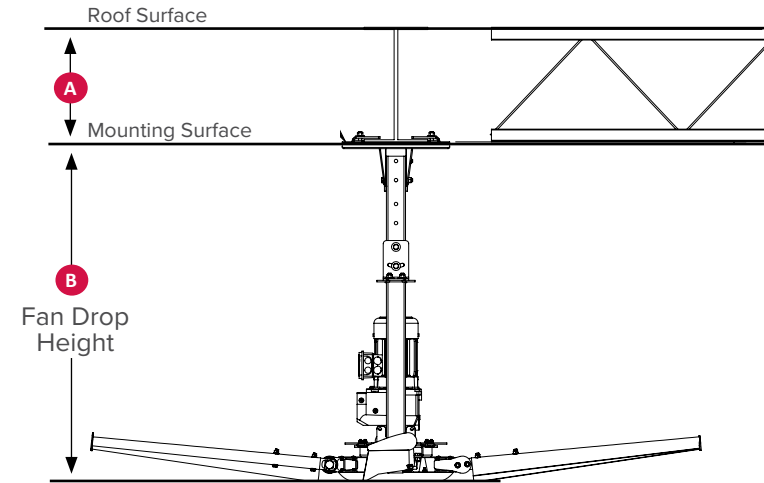

Voltage/Phase

- 200-240V / 1 phase
- 200-240V / 3 phase
- 400-480V / 3 phase

Custom Color: Blades and Hub

- No. Standard Mill Finish
- Yes.
- RAL K5# _____ (20% gloss)

Network Cable Length

- 75'
- 150' (standard)

Custom Logo

- No
- Yes. Custom Specifications

600 Volt Transformer

Typically required for Canada*

- No
- * Yes (requires 480V / 3 phase)

Hub Cover

- No
- Yes

Note: Hub cover is required when selecting a custom logo.

EMC Compliance

- No
- Yes

Shipment Destination

- North America
- International

Power Disconnect

- No (supplied locally)
- Yes

Motor Shrouds

- No
- Yes

Note regarding fan controls:
 A Single Fan Controller will be shipped with every Revolution LT fan.
 It is NOT necessary to order controls separate with this fan model.



A19REVLTS0422H1

8900 North Arbon Drive
 Milwaukee, WI 53223, USA

P 414-355-2600 (800-456-0600)

F 414-355-9248

Rite-Hite® and Revolution® are trademarks of Rite-Hite Holding Corporation. Rite-Hite products are covered by one or more U.S. patents with other U.S. and foreign patents pending. The information herein is provided as a general reference only regarding the use of the applicable products. The specifications stated here are subject to change. Manufactured by: Rite-Hite Engineered Solutions Group, Inc.

www.ritehite.com